

PRODUCT DATA SHEET

ISO-CONNECT INSIDE FD



PRODUCT DESCRIPTION

ISO-CONNECT INSIDE FD is an extremely flexible and stretchable special foil for an air and vapour tight seal on window, door and panel connecting joints.

ISO-CONNECT INSIDE FD consists of a flexible soft synthetic fleece, which is equipped with a self-adhesive strip on one edge for easy and effective application on window and door frames. The water vapour diffusion impermeable fleece membrane provides a reliable separation between internal and external conditions and complies with the requirements of the energy saving regulation (EnEV) as well as the RAL "installation guide".

APPLICATION

ISO-CONNECT INSIDE FD is a system component of the ISO³-WINDOW SEALING SYSTEM and is used to seal internal window and door connecting joints.

The special versatile foil is very flexible in its application and is characterised through its low inherent rigidity, allowing problem-free application around corners and conforms to different shapes.

Due to the extremely high elasticity of the material it is particularly suitable for the reliable sealing of moving joints. Even on extreme movements between elements the flexible window connecting film ensures a high ultimate tensile strength.

PRODUCT ADVANTAGES

- high elasticity and flexible adaptation, compensates joint movement
- low inherent rigidity and at the same time high ultimate tensile strength for easy and effective application
- complies with the requirements of the energy saving regulations (EnEV)
- air tight, wind proof and vapour diffusion impermeable
- driving rain and water resistant
- special fleece surface to enable plastering, painting or pasting over
- with self-adhesive strip for easy installation

SERVICE

- standard sizes available from stock
- private label and / or special labelling available
- competent experienced technical support available in the field and by phone

DIMENSIONS

width finish SK: 70, 90, 145, 180, 235, 290 mm
width finish COMPLETE: 70, 100, 140, 200 mm
width finish COMPLETE DUO: 70, 100, 140 mm



ISO-CONNECT INSIDE FD

Technical data	Standard	Classification
Material description		vapour diffusion impermeable synthetic fleece
Colour		blue
Weight		approx. 180 g/m ²
Impermeable to driving rain	DIN EN 1027	no water penetration up to 1,050 Pa
Air permeability coefficient	DIN EN 12114	$\alpha < 0.1$ (no measurable air penetration)
Temperature stability range	internal	approx. -40 °C to +80 °C
sd-value	DIN EN ISO 12572	approx. 39 m
Flexibility at -23 °C	internal	no breaks, no tears
Fire behaviour	DIN EN 13501	E
Dimension tolerance	DIN 7715 T5 P3	requirements fulfilled
Shelf life		1 year, dry and in original packing
Storage temperature		+1 °C to +20 °C

PROCESSING

The bonding surfaces must be firm, dry, clean from dust, stripping agents, solvents, oil and grease. When sealing window, panel and door frame connections remove backing from the self-adhesive strip, then lay the foil into position and press firmly. ISO-CONNECT INSIDE FD can be applied in the factory or workshop.

For bonding to walls ISO-TOP FLEX-ADHESIVE SP or SP+ is used. Normal rough, e.g. uneven wall surfaces, can be compensated for through the application of a sufficient amount of adhesive. Use sufficient adhesive so that after applying the foil the adhesive caterpillar is at least 30 mm wide and 1 mm thick. On areas that are to be plastered over a continuous "Z" shaped caterpillar should be applied over the area. Depending on the μ -values of the surface it can be necessary to increase the width of the adhesive caterpillar up to ≥ 50 mm, in order to reduce the water vapour permeability. Overlapping of the foil ends should only be up to 50 mm wide using the same technique. Plastering over can be done as soon as the adhesive bond is enough to carry the weight of the plaster.

FINISHES

- finish SK: single side self-adhesive with 1 self-adhesive strip
- finish COMPLETE: full surface adhesive finish with a 2-way or 3-way split liner
- finish COMPLETE DUO: full surface adhesive finish with a 2-way or 3-way split liner and 1 self-adhesive strip (window mounting)
- special finishes available on request

PACKAGING

rolls, roll length: 30 m

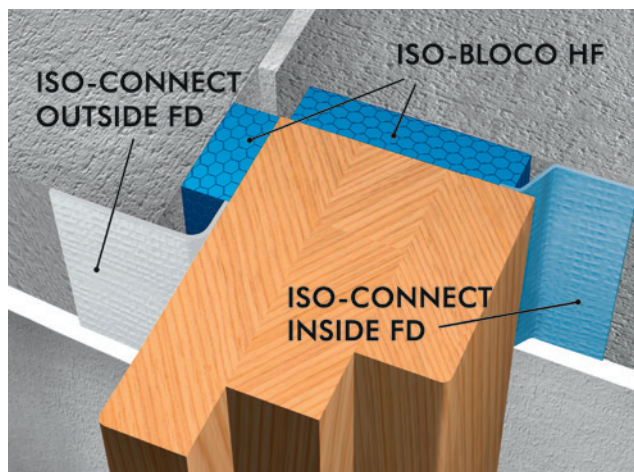

Installation example: ISO³-WINDOW SEALING SYSTEM