

# PRODUCT DATA SHEET

## ISO-CONNECT KSKSEAL



### PRODUCT DESCRIPTION

ISO-CONNECT KSKSEAL is an all-over self-adhesive, flexible sealing membrane made of polymer-modified bitumen with a flexible yet tearproof HDPE foil and is used for the external sealing of window and door elements in facade constructions. ISO-CONNECT KSKSEAL protects components in contact with the ground permanently against non-pressurised water as per DIN 18195-5 for sealing thresholds, ground moisture (capillary and retained water) and non-accumulating seepage water (DIN 18195-4).

### APPLICATION

ISO-CONNECT KSKSEAL has been designed for the correct physical external sealing of bottom joints on doors and floor-length windows to the perimeter area in accordance with DIN 18195-5. The transition to further bituminous sealing in the perimeter area is thus possible conforming to material requirements.

### FINISHES

Completely self-adhesive with separate release paper:

- 100 – 200 mm width with a longitudinal perforation
- 250 – 300 mm width with two longitudinal perforations
- 350 mm width with three longitudinal perforations

### PRODUCT ADVANTAGES

- can be installed all year round
- no hard-drying necessary
- immediately resistant to water and driving rain
- no waiting times
- flexible, resilient and crack-covering
- highly resistant to all aggressive substances which naturally occur in soil
- perforated release paper for easier fitting

### DIMENSIONS

width: 100, 150, 200, 250, 300, 350 mm  
further widths and thicknesses available on request

### PACKAGING

rolls, roll length: 20 m

# ISO-CONNECT KSKSEAL

Technical data	Standard	Classification
Material description		polymer-modified bitumen on tear-resistant HDPE
Colour		black
Building material class	DIN EN 13501	E
Bitumen compatibility	DIN 7864 T1	bitumen-compatible
Water vapour diffusion resistance $\mu$		168,500 / sd-value 252 m
Material thickness		1.5 mm
Handling temperature		-5 °C to +30 °C
Dimensional tolerance	DIN 7715 TP P3	DIN EN 1848-1 fulfilled
Storage temperature		+5 °C to +30 °C stored in a vertical position
Shelf life		12 months

## PREPARATION

Unroll the ISO-CONNECT KSKSEAL sealing foil and cut it to the required length. The area to be bonded must be clean, dry, free of solvents, greases, dust, oil and other anti-adhesive substances.

## PROCESSING

Where necessary treat the area to be bonded with ISO-TOP KSKSEAL PRIMER and then apply the self-adhesive backing to the area to be bonded/sealed and press into place carefully using a roller so that the product is moulded to the contours of the substrate. On the top edge of the seal a flashing strip (ISO-BUTYL FLEECE TAPE) may be required. Additional mechanical fixing, e.g. supporting lath, clamping bar and fastening to the window, should, as specified in DIN 18195, be mounted.

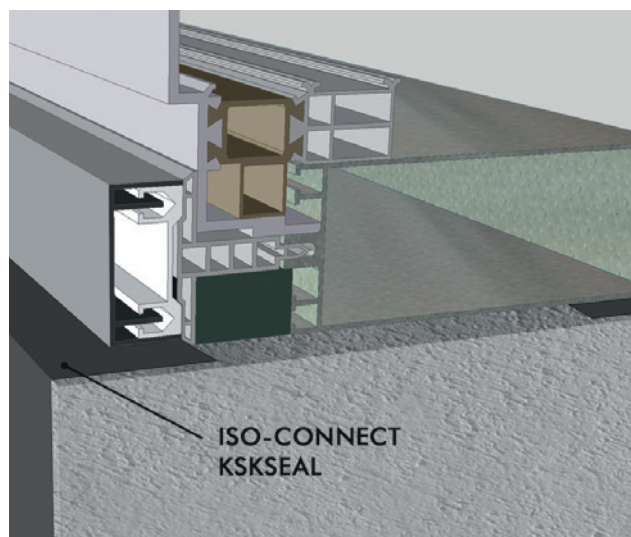

Installation example: ISO-CONNECT KSKSEAL